



# WRITE PROTECTION

Since July 2012 the UP panel pc will be delivered with a new and “easy to use” write protection control.

How do you handle this, here a short introduction.



Abbildung 1: Schreibschutz aktivieren

## (1) Status indicator disable

Click on the indicator to open the state indicator window. With the Button enable the write protection will be activated, during this time this process can be interrupted with cancel.

**Default path is C:/homecockpit/WriteProtectionGui.exe**

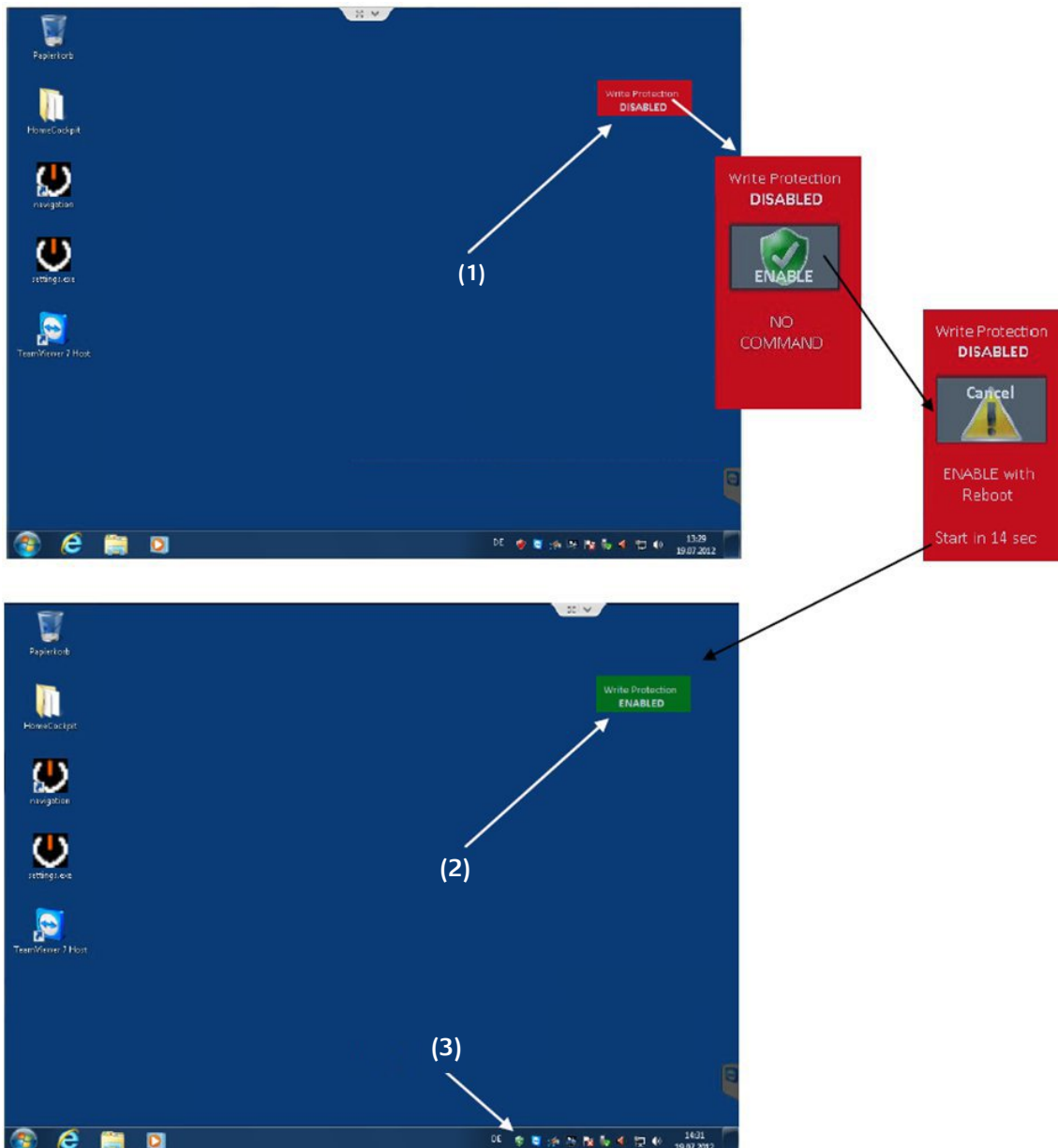
## (2) Status indicator enable

After rebooting, the indicator turns green, the write protection is active.

## (3) Write protection Symbol

Das Icon des Schreibschutz finden Sie in der Taskleiste.



### Write protection menu (Symbol in the Windows bar)

1. „Disable Live“ Disable write protection, till the next reboot of the panel  
**(will not reboot the panel pc)**
2. „Disable“ Disable write protection complete, also after a reboot of the panel  
**(will reboot the panel)**
3. „Commit“ Commit changes; write protection will stay enabled  
**(will reboot the panel) (Default)**
4. „Auto Start“ The Auto start of the write protection  
**(Default)**
5. „Hide“ Shows/hide the state indicator on the desktop. With a click on the System tray icon, the state indicator will show again
6. Settings will be saved and menu is closed.





b.a.b – technologie gmbh

im INHOUSE Dortmund  
Rosemeyerstr. 14  
44139 Dortmund

[info@bab-tec.de](mailto:info@bab-tec.de)

Tel.: +49 (0) 231 – 476 425 - 30  
Fax.: +49 (0) 231 – 476 425 - 59  
[www.bab-tec.de](http://www.bab-tec.de)